

Key Features

- 5 Bedrooms
- 5 Bathrooms
- Galleried Landing
- Impressive 23ft Entrance Hall
- 5 Reception rooms
- Well fitted Kitchen / Breakfast room
- Double Garage and parking
- Level private garden

Description

**** SOLD STC **** Elsewhere are delighted to announce the availability of this most impressive 5 Bedroom detached family home. The property is enviably located within a gated private road. The current owners have maintained their home to a high standard and this fine home offers an exceptionally spacious interior including 5 Bedrooms, 5 Bathrooms (4 Ensuite), 5 Reception rooms, 20ft x 17ft Kitchen/Breakfast room. In addition, the level rear garden offers a high degree of privacy. Double Garage and ample parking. An inspection is strongly recommended. **** SIMILAR REQUIRED ****



Total Approximate Floor Area
3250 Square feet
302 Square metres

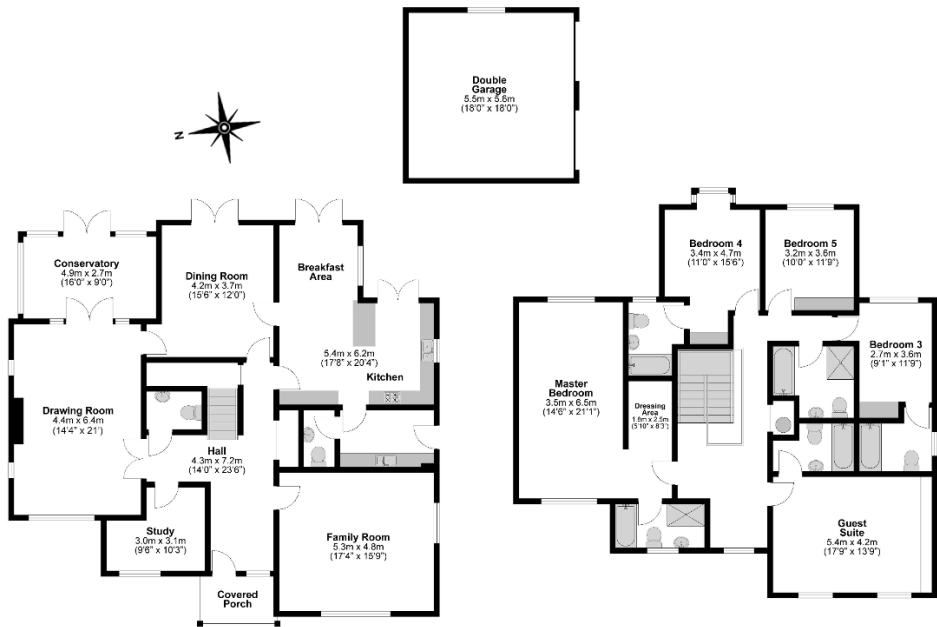

**Illustrations are for identification purposes only,
measurements are approximate, not to scale.**