

## Key Features

- 4 Bedrooms
- 2 Bathrooms (one ensuite)
- 25ft Living room
- 25ft Family room / Living room
- Dining room
- Modern 14ft Kitchen / Breakfast room
- Quietly located
- Garage and parking



## Description

**\*\* SOLD STC \*\*** Elsewhere are delighted to offer this well presented 4 Bedroom detached family home. The spacious interior includes a stunning 25ft x 22ft open plan Family / Dining room with bi-fold doors onto the terrace plus a superbly fitted 14ft Kitchen. Quietly located within a pleasant cul de sac, close to local amenities and open countryside. Garage, ample parking. Pleasant Garden. The discerning buyer will be most impressed with this fine home and a visit is highly recommended

CONTACT US TO VIEW or BOOK YOUR VIEWING 24/7 ON LINE

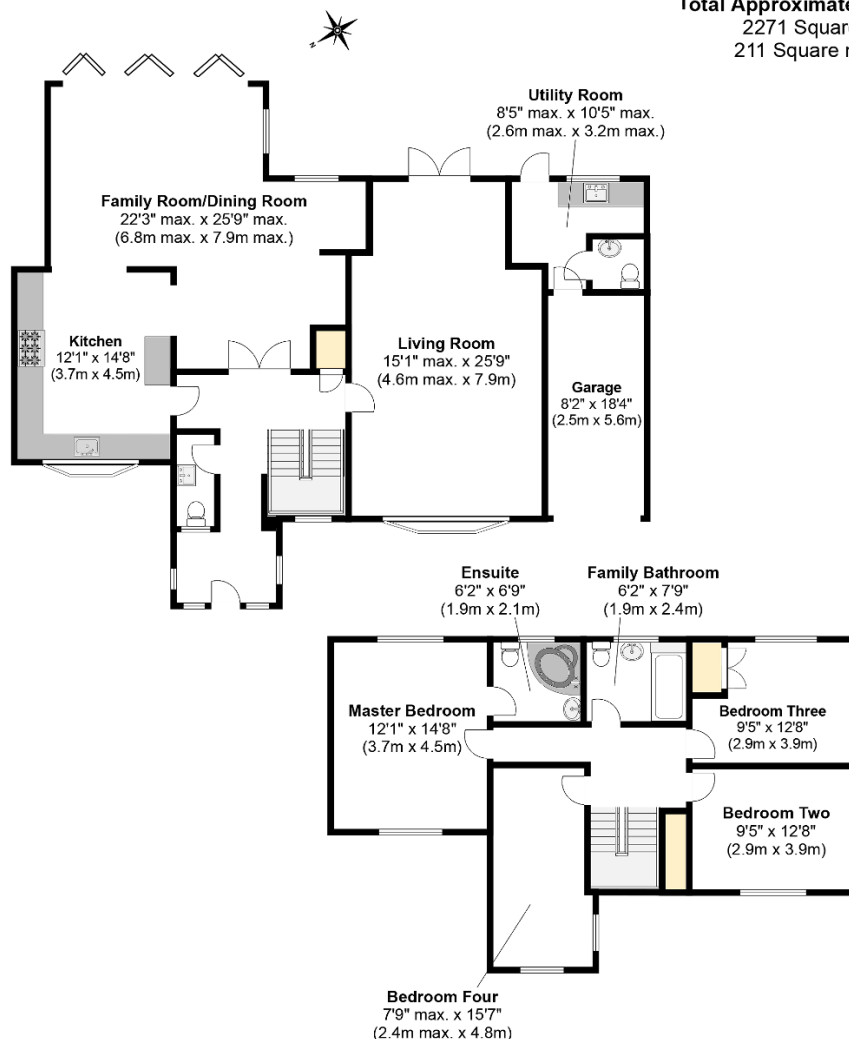

**Total Approximate Floor Area**  
2271 Square feet  
211 Square metres

Illustrations are for identification purposes only, measurements are approximate, not to scale.