



Key Features

- Superbly presented • 4 Bedrooms • Ensuite shower room • Bathroom + Cloakroom • 2 / 3 Reception rooms • Superb 22ft Kitchen / Family room • Parking for 3 cars + visitor parking • Landscaped south facing garden

Description

**** SALE AGREED **** Elsewhere are delighted to offer this immaculately presented 4 Bedroom semi-detached home. The spacious interior is stunning including a 22ft x 22ft open plan Kitchen / Family room. Quietly located within a private no through road, close to open fields as well as beautiful woodland walks at nearby Black Park and Langley Park. The property was constructed by Linden Homes in 2016 with 7 years NHBC warranty remaining. An inspection is highly recommended. EPC Grade B

CONTACT US TO VIEW or BOOK YOUR VIEWING 24/7 ON LINE
WWW.ELSE-WHERE.CO.UK

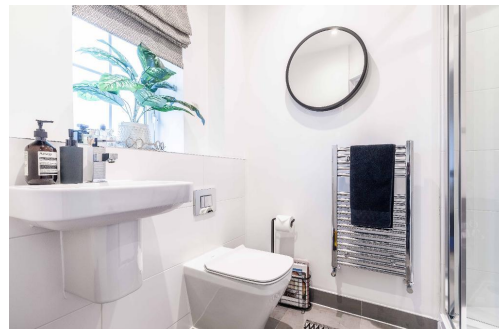

Total Approximate Floor Area
1400 Square feet
130 Square metres

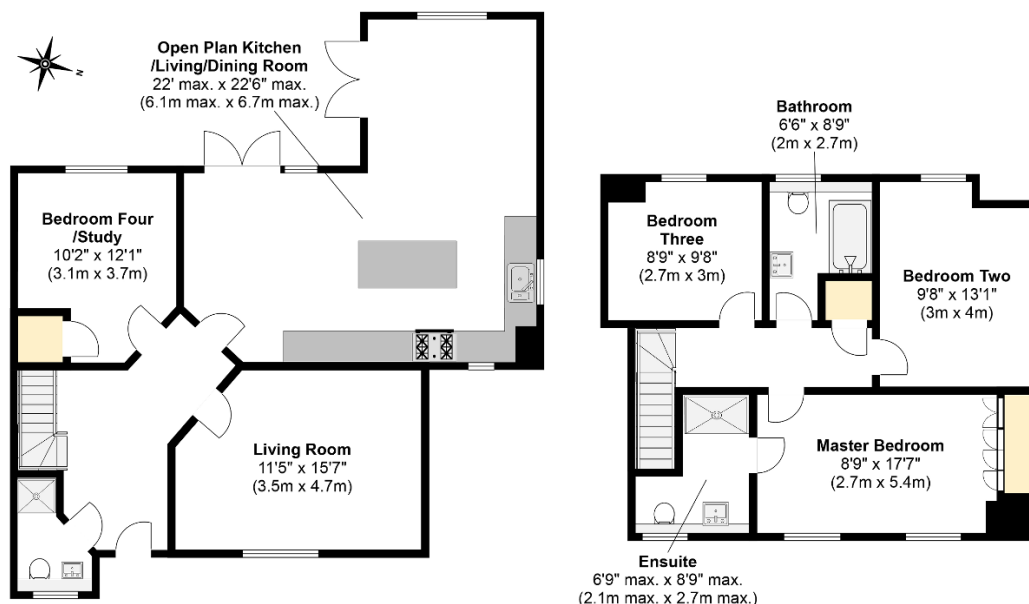

Illustrations are for identification purposes only, measurements are approximate, not to scale.