

## Key Features

- 2 Bedrooms
- Bathroom
- Living Room
- Kitchen
- Ample storage
- Parking for 2 cars
- No through road
- Garden



## Description

**\*\* Sold STC \*\*** Elsewhere are delighted to offer this well maintained ground floor flat is worthy of an early inspection. There are 2 good size Bedrooms, own private garden to the rear as well as parking for two cars plus a large storage unit. Quietly located within a private no through road bordering Farnham Royal. Long lease: 956 years unexpired. No onward chain. EPC D **\*\* Agreed within days of entering the market \*\***

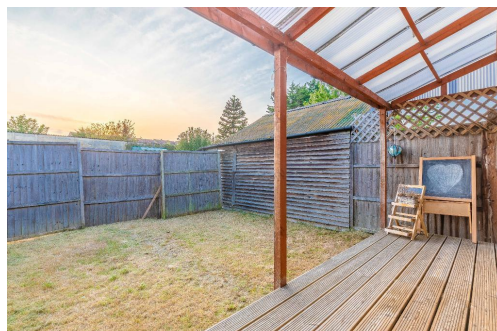

**Total Approximate Floor Area**  
490 square feet  
45.5 square meters

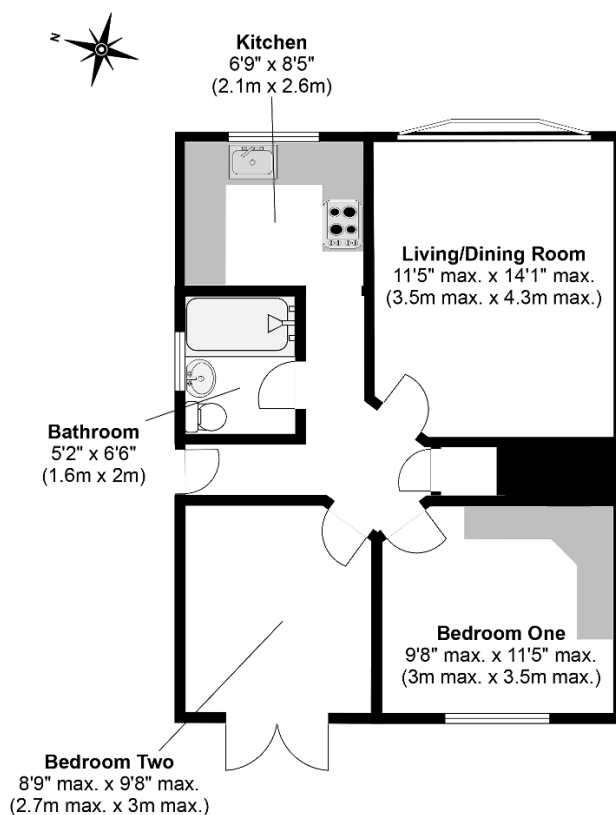

Illustrations are for identification purposes only,  
measurements are approximate, not to scale.