



## Key Features

- LARGE ONE BEDROOM APARTMENT
- GROUND FLOOR
- PRIVATE TERRACE
- ONLY FOUR YEARS OLD
- SIX YEARS NHBC WARRANTY
- ALLOCATED PARKING
- CLOSE TO STATION
- CLOSE TO HIGH STREET



## Description

Elsewhere are pleased to present this STUNNING ONE BEDROOM apartment built by Linden Homes just four years ago. The property boasts light and SPACIOUS accommodation throughout and features include a large double bedroom with built-in wardrobes, modern bathroom, stylish kitchen, large living room, private terrace, ALLOCATED PARKING and huge storage cupboard.

Pennymans Court is accessed via Dolphin Road, and is just a short walk from Sainsbury's supermarket. Slough Station and the High Street are also within walking distance.



### Pennymans Court, Denton Way, Slough, SL3

APPROX. GROSS INTERNAL FLOOR AREA 548 SQ FT 50.9 SQ METRES

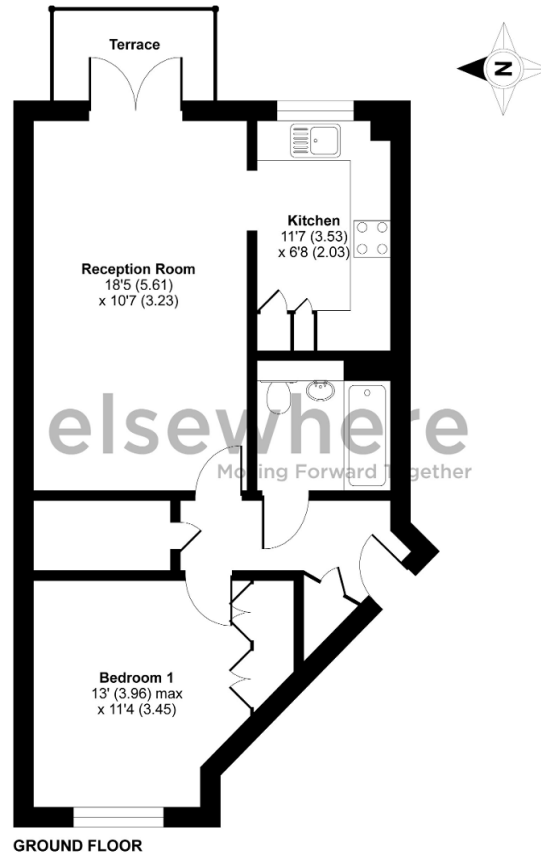

Whilst every attempt has been made to ensure the accuracy of the floor plan contained here, measurements of doors, windows and rooms are approximate and no responsibility is taken for any error, omission or misstatement. These plans are for representation purposes only as defined by RICS Code of Measuring Practice and should be used as such by any prospective purchaser. Specifically no guarantee is given on the total square footage of the property if quoted on this plan. Any figure given is for initial guidance only and should not be relied on as a basis of valuation.

Copyright nichecom.co.uk 2018 Produced for Elsewhere REF : 365891